

Deck Layout

**All decking is to be 5/4 x 6 wood material or approved equal

Maximum 2-Ply Beam Length			
Supported Joist Length	2 x 8	2 x 10	2 x 12
4'-0"	11'-7"	14'-10"	17'-4"
6'-0"	9'-10"	12'-1"	14'-0"
8'-0"	8'-7"	10'-6"	12'-3"
10'-0"	7'-8"	9'-4"	10'-8"
Maximum 3-Ply Beam Length			
8'-0"	10'-8"	13'-0"	15'-1"
10'-0"	9'-6"	11'-8"	13'-6"

Maximum Floor Joist Length		
Joist Size	Max. Span	Max. Cantilever
2x8 @ 12" O.C.	12'-6"	20"
2x8 @ 16" O.C.	11'-9"	16"
2x8 @ 24" O.C.	11'-0"	14"
2x10 @ 12" O.C.	14'-6"	28"
2x10 @ 16" O.C.	13'-8"	24"
2x10 @ 24" O.C.	12'-10"	20"
2x12 @ 12" O.C.	16'-5"	28"
2x12 @ 16" O.C.	15'-6"	24"
2x12 @ 24" O.C.	14'-6"	20"

* Install solid blocking when floor joist span exceeds 6'-10". Blocking required to be of the same material and size as the floor joist and located not more than 6'-10" from each support and other rows of blocking.

* Decay-resistant lumber shall be installed, as noted within the 2012 MMAH Supplementary Standard SB-7. See note on page three.



MIN. GUARD HEIGHT WITH DECKS:
 - 5'-11" OR LESS ABOVE GROUND = 36"
 - MORE THAN 5'-11" ABOVE GROUND = 42"

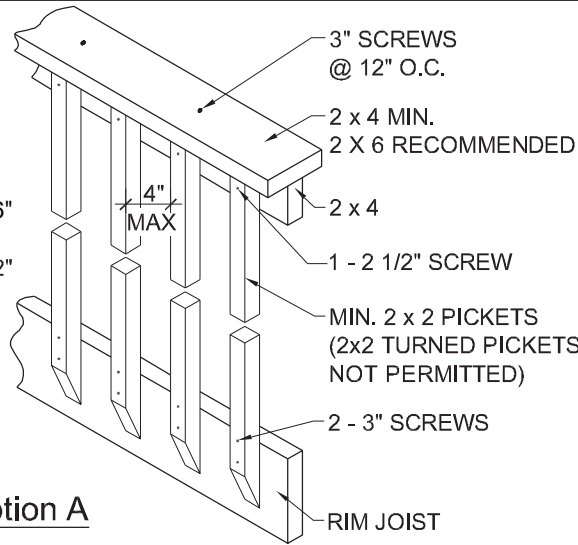

Option A

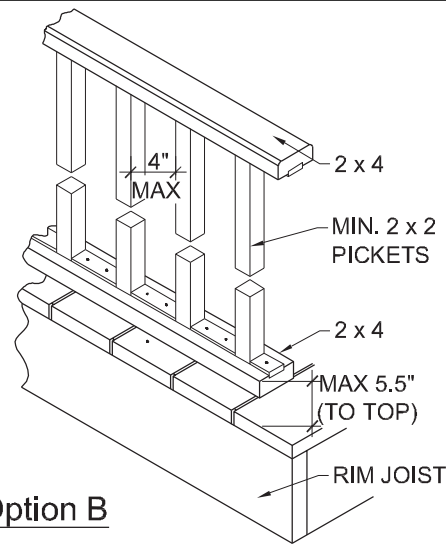

Option B

NOTE: ANYTHING OTHER THAN A WOOD GUARD/RAILING, PLEASE SUBMIT A COPY OF THE PRE-ENGINEERED GUARD/RAILING DETAILS AND TESTING REPORTS WITH YOUR BUILDING PERMIT APPLICATION.

NOTE: SEE PAGE THREE FOR GUARD POST DETAIL

Guard Details

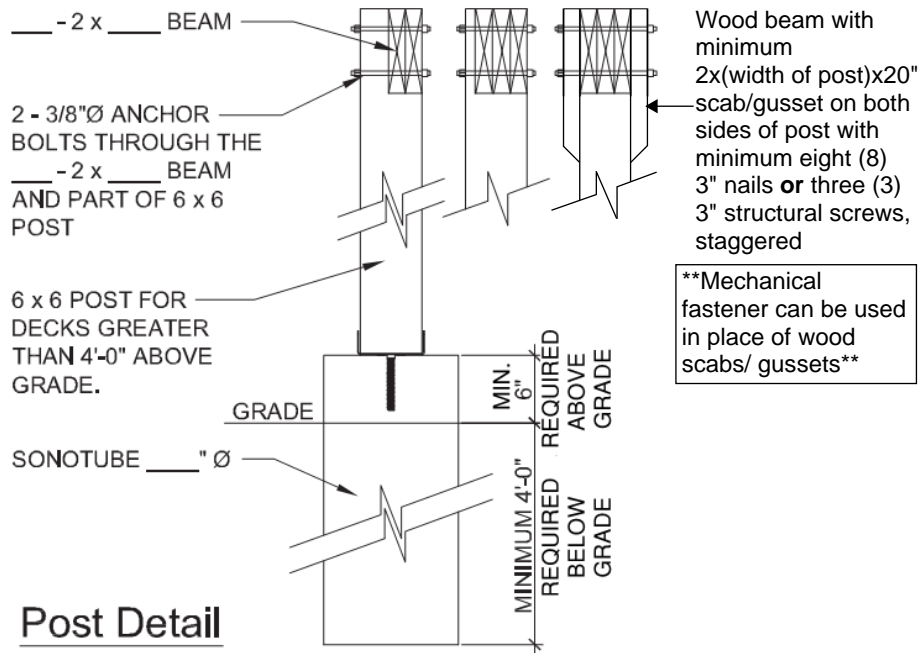

Post Detail

**SOLID BLOCKING REQUIRED FOR BEAMS @ 16" O.C.

**ADDITIONAL LATERAL BRACING MAY BE REQUIRED. CONFIRM WITH BUILDING INSPECTOR @ FRAMING INSPECTION.

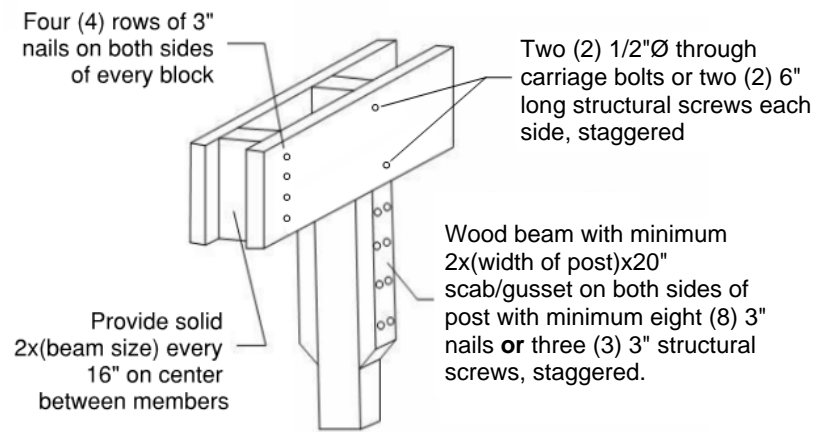

Box Beam Detail

**SOLID BLOCKING REQUIRED FOR BEAMS @ 16" O.C.

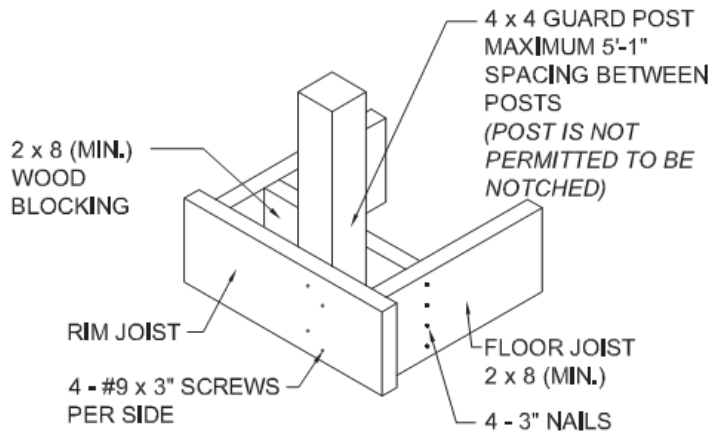

Guard Post Detail



MINIMUM 1/2"Ø ANCHOR BOLTS AT 16" CENTERS, STAGGERED. ANCHOR BOLTS MUST BE INTO WOOD FRAMING OR FOUNDATION WALL.
DO NOT SECURE INTO BRICK VENEER ALONE.

Ledge Board Fastener Spacing

**** JOIST HANGER NAILS REQUIRED****

Ledge Board Connection to Rim Board

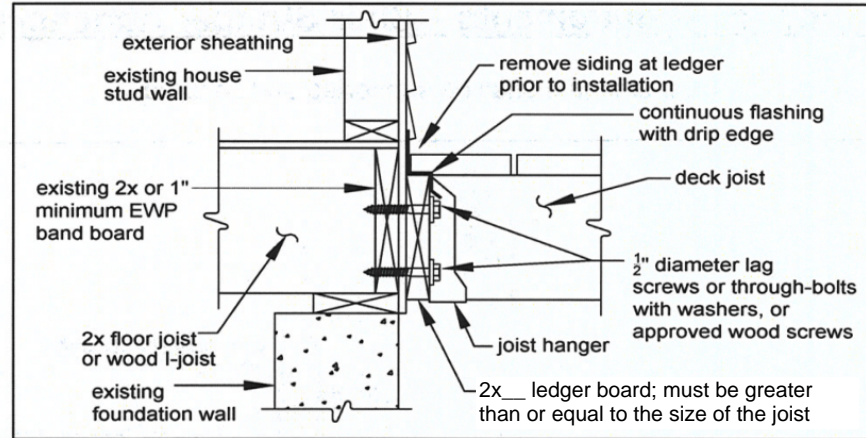

Ledge Board Connection to Poured Foundation Wall

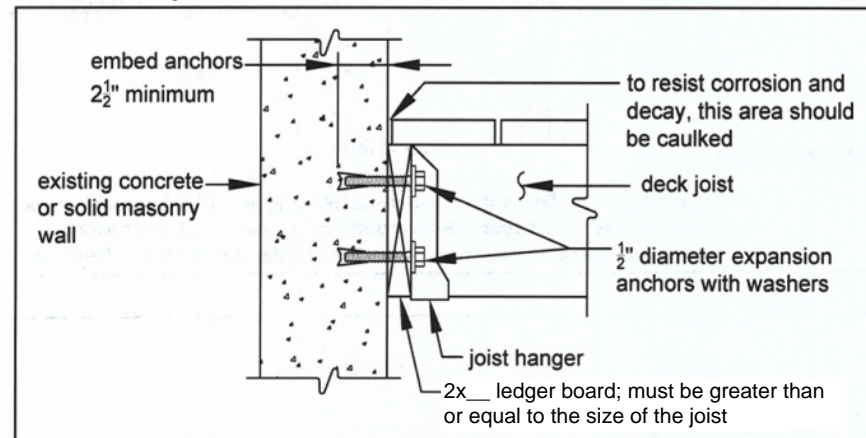

Ledge Board Connection to Block Wall

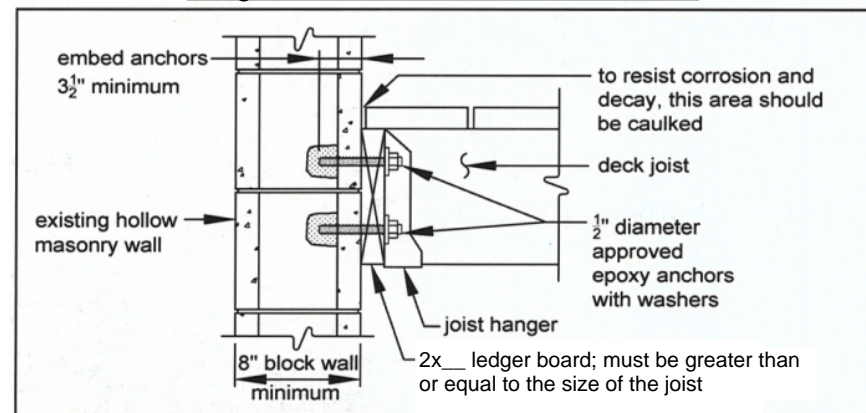

FROM 2012 MMAH SUPPLEMENTARY STANDARD SB-7:
 SENTENCE 2.1.5. **DECAY-RESISTANT LUMBER** (SEE APPENDIX A.)
 (1) LUMBER FOR GUARD SYSTEMS AND FLOOR SYSTEMS SHALL BE
 (a) A SPECIES RESISTANT TO DECAY,
 (b) PRESERVATIVE TREATED TO PREVENT DECAY, OR
 (c) PRESSURE-TREATED.
 (2) ALL CUT ENDS OF PRESERVATIVE TREATED LUMBER SHALL BE
 TREATED TO PREVENT DECAY.

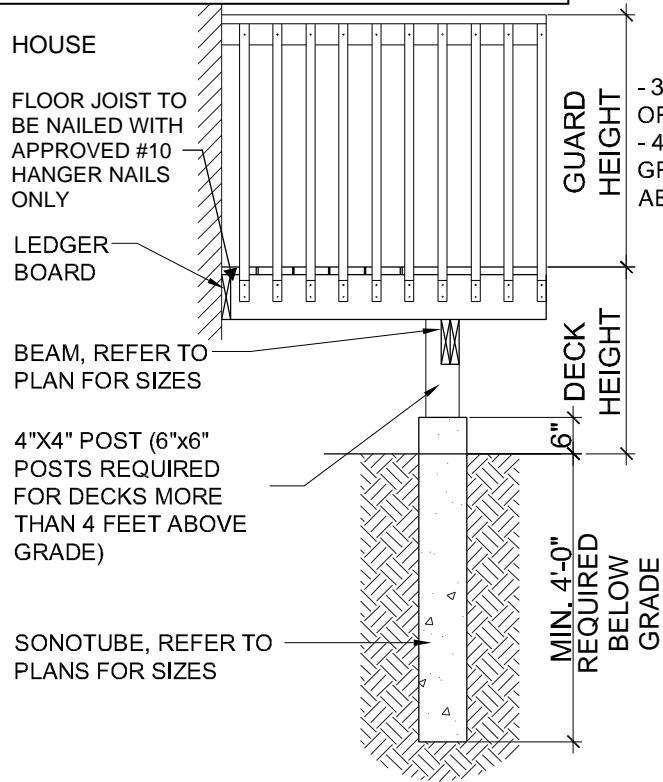

Deck Elevation

- 36" FOR DECKS 5'-11"
 OR LESS ABOVE GRADE
 - 42" FOR DECKS
 GREATER THAN 5'-11"
 ABOVE GRADE.

Sonotube Sizes

Diameter	*Weight
8"Ø	1047 lbs
10"Ø	1635 lbs
12"Ø	2355 lbs
14"Ø	3207 lbs
16"Ø	4189 lbs

*Weight = (supported joist length each side of post x half beam length each side of post) x 50 lbs/SF

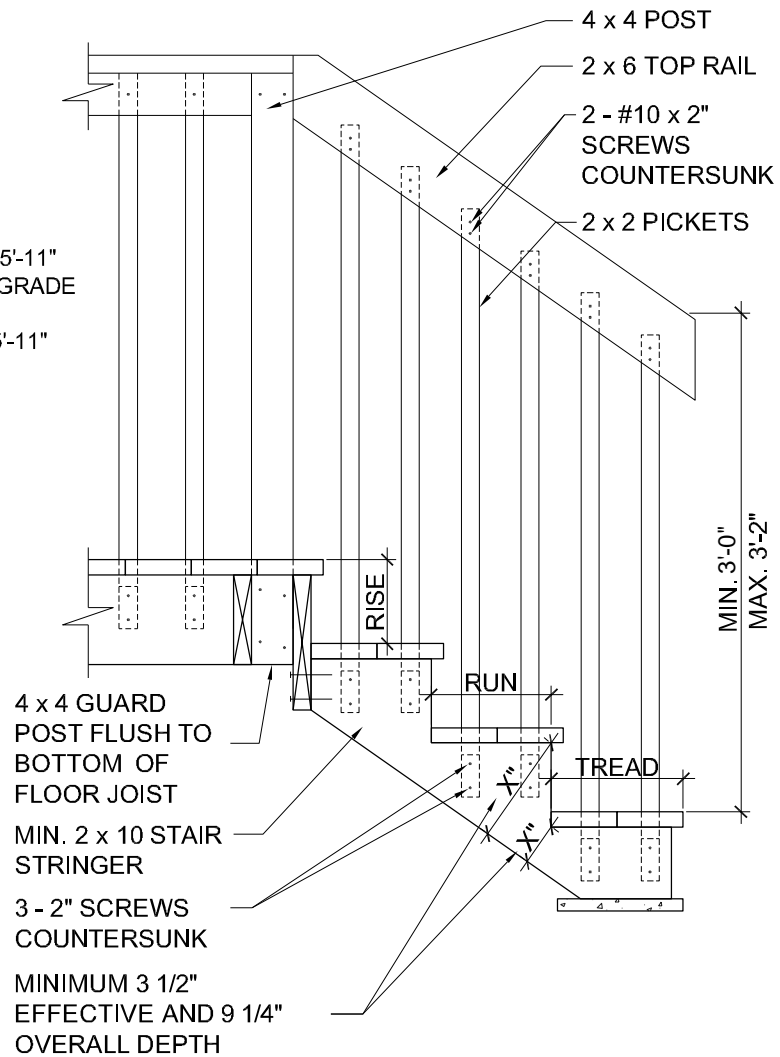

Stair Detail

Stair Dimensions		
Type	Max.	Min.
Rise	7 7/8"	5"
Run	14"	10"
Tread	15"	11"

*Risers shall have a uniform height in any one flight of stairs.
 *Treads shall have a uniform run and tread depth in any one flight of stairs.

